



Pneumatic Sales Resource



# The RHINO Difference

How Rhino Pneumatic Tools drive your productivity and profits



Pneumatic • Hydraulic • Gasoline  
Professional Grade Tools



## Trusted

For over 45 years Rhino pneumatic post drivers have established a reputation for being reliable, durable and powerful. One moving part, a reciprocating piston, and low air consumption, along with the use of our recommended Filter-Regulator-Lubricator, have made this tool a solid investment with minimal maintenance.



## Fast

Rhino pneumatic post drivers drive posts quickly and easily. The PD-55 can deliver up to 1700 blows per minute, these post drivers can drive in difficult job sites where space is limited, with minimal manpower and maximum efficiency. The PD-110/140/200 can deliver up to 900 bpm for larger posts.



## Productive

A wide range of Rhino accessories allows you to use one post driver for many applications. Easy to change, bolt-on chucks, and bolt-in adapters, combined with hardened drive caps that are designed to fit different posts, keeping the driver aligned and reduces damage to the post.



## Versatile

Rhino pneumatic drivers meet the needs of your jobsite. Light or Heavy duty drivers handle U-Channel, ground rod, T-post, concrete form pin, I-beam, metal and wood posts. Our customizable drivers can solve most post driving challenges.



## Product Support

Rhino Tool Company regional sales representatives, internal customer service associates, and factory service technicians are ready to assist with product selection or repair.



## Satisfaction Guarantee

Rhino stands behind the professional grade tools that we supply. If a Rhino Pneumatic Tool was selected and purchased through an authorized Rhino Distributor/Dealer, and you are not satisfied with its performance after the first 14 days of operation - contact Rhino at [customersatisfaction@rhinotool.com](mailto:customersatisfaction@rhinotool.com) to discuss your concerns. Rhino will resolve your issue with a needed accessory, change to a more appropriate model, or product return.

# The RHINO Difference

**How Rhino Pneumatic Post Drivers and accessories, drive your productivity and profits**

| Features  | Benefits  |
|---|---|
| <ul style="list-style-type: none"><li>• Efficient Power</li></ul>   | <ul style="list-style-type: none"><li>• Increased productivity with less air consumption than much larger, bulkier tools traditionally used.</li></ul>              |
| <ul style="list-style-type: none"><li>• Filter-Regulator-Lubricator</li></ul>   | <ul style="list-style-type: none"><li>• Recommended to keep, post driver clear of debris, proper pressure, and the driver lubricated, extending tool life</li></ul> |
| <ul style="list-style-type: none"><li>• One moving part, a double valve and reciprocating piston.</li></ul>                     | <ul style="list-style-type: none"><li>• Ensures low-maintenance and longevity.</li></ul>  |
| <ul style="list-style-type: none"><li>• Additional driving options possible with bolt-on chucks and separate adapters</li></ul> | <ul style="list-style-type: none"><li>• Capable of driving a wider variety of post types.</li></ul>   |
| <ul style="list-style-type: none"><li>• Compact, yet powerful enough to drive up to 6 in O.D. Round Pipe</li></ul>              | <ul style="list-style-type: none"><li>• Fits into tight jobsites. Lift arm recommended for PD-110, PD-140 and PD-200 models.</li></ul>                              |
| <ul style="list-style-type: none"><li>• Easy to use, easy to maintain</li></ul>   | <ul style="list-style-type: none"><li>• Less downtime for training or tool repairs</li></ul>  |
| <ul style="list-style-type: none"><li>• Quality American craftsmanship, trusted for decades.</li></ul>                          | <ul style="list-style-type: none"><li>• Reliable, trouble-free operation with minimal service.</li></ul>  |
| <ul style="list-style-type: none"><li>• Satisfaction Guarantee</li></ul>  | <ul style="list-style-type: none"><li>• Worry-free purchase</li></ul>   |



# Pipe Driving Chart

## For Rhino Pneumatic Post Drivers



Pneumatic • Hydraulic • Gasoline  
Professional Grade Tools

All round pipe applications shown are Schedule 40. Measure Inner Diameter (I.D.) of pipe to find applicable accessory. Refer to the Rhino Chuck Sizing Guide for more information on the chucks listed below.

| PIPE SIZE (MM) | Post Driver | Drive Cap       | Master chuck (mm) | Chuck P/N | Adapter (mm) | Adapter P/N | Master chuck (mm) | Master Chuck P/N | Adapter (mm)  | Adapter P/N |
|----------------|-------------|-----------------|-------------------|-----------|--------------|-------------|-------------------|------------------|---------------|-------------|
| 2 in (50.8)    |             |                 |                   |           |              |             |                   |                  |               |             |
|                | PD-55       | 071260 Optional | 3-7/8"(98.425)    | 070592    | 2-1/2"       | 070611      | 4-1/4" (108)      | 070060           | 2-1/2"(63.5)  | 070624      |
|                | PD-110      |                 | 4-1/4" (108)      | 070593    | 2-1/2"       | 070624      | N/A               |                  | N/A           |             |
|                | PD-140      |                 | 4-1/4"(108)       | 070594    | 2-1/2"       | 070636      | N/A               |                  | N/A           |             |
|                | PD-200      |                 | 5-1/2"(140)       | 070746    | 2-1/2"       | 070842      | 7" (178)          | 070758           | 2-1/2" (63.5) | 070839      |
| 2.5 in (63.5)  |             |                 |                   |           |              |             |                   |                  |               |             |
|                | PD-55       | 071261 Required | 3-7/8"(98.425)    | 070592    | 3" (76)      | 070610      | 4-1/4" (108)      | 070060           | 3" (76)       | 070623      |
|                | PD-110      | 071261 Optional | 4-1/4" (108)      | 070593    | 3" (76)      | 070623      | N/A               |                  | N/A           |             |
|                | PD-140      |                 | 4-1/4" (108)      | 070594    | 3" (76)      | 070635      | N/A               |                  | N/A           |             |
|                | PD-200      |                 | 5-1/2"            | 070746    | 3-1/8"(79)   | 070782      | 7" (178)          | 070758           | 3-1/8" (79)   | 070786      |
| 3 in (76.2)    |             |                 |                   |           |              |             |                   |                  |               |             |
|                | PD-55       | 071262 Required | 3-7/8"(98.425)    | 070592    | Not Needed   |             | 4-1/4"(108)       | 070060           | 3-5/8" (92)   | 070622      |
|                | PD-110      |                 | 4-1/4"(108)       | 070593    | 3-5/8" (92)  | 070622      | N/A               |                  | N/A           |             |
|                | PD-140      |                 | 4-1/4"(108)       | 070594    | 3-5/8" (92)  | 070634      | N/A               |                  | N/A           |             |
|                | PD-200      |                 | 5-1/2"(140)       | 070746    | 3-3/4" (95)  | 070783      | 7" (178)          | 070758           | 3-3/4" (95)   | 070787      |
| 3.5 in (88.9)  |             |                 |                   |           |              |             |                   |                  |               |             |
|                | PD-55       | 071263 Required | N/A               |           | N/A          |             | 4-1/4" (108)      | 070060           | Not Needed    |             |
|                | PD-110      |                 | 4-1/4"(108)       | 070593    | Not Needed   |             | N/A               |                  | N/A           |             |
|                | PD-140      |                 | 4-1/4"(108)       | 070594    | Not Needed   |             | N/A               |                  | N/A           |             |
|                | PD-200      |                 | 5-1/2"(140)       | 070746    | 4-1/4" (108) | 070784      | 7" (178)          | 070758           | 4-1/4" (108)  | 070788      |
| 4 in (101.6)   |             |                 |                   |           |              |             |                   |                  |               |             |
|                | PD-55       | N/A             | N/A               |           | N/A          |             | N/A               |                  | N/A           |             |
|                | PD-110      | 071264 Required | 4-3/4" (120)      | 070644    | Not Needed   |             | N/A               |                  | N/A           |             |
|                | PD-140      |                 | 4-3/4" (120)      | 070644    | N/A          |             | N/A               |                  | N/A           |             |
|                | PD-200      |                 | 5-1/2"(140)       | 070745    | 4-3/4" (120) | 070785      | 7" (178)          |                  | 4-3/4" (120)  | 070789      |
| 5 in* (127)    |             |                 |                   |           |              |             |                   |                  |               |             |
|                | PD-55       | 071295 Required | N/A               |           | N/A          |             | N/A               |                  | N/A           |             |
|                | PD-110      |                 | N/A               |           | N/A          |             | 7" (178)          |                  | 5-3/4"(146)   | 070791      |
|                | PD-140      |                 | N/A               |           | N/A          |             | 7" (178)          |                  | 5-3/4"(146)   | 070791      |
|                | PD-200      |                 | N/A               |           | N/A          |             | 7" (178)          |                  | 5-3/4"(146)   | 070791      |
| 6 in* (152.4)  |             |                 |                   |           |              |             |                   |                  |               |             |
|                | PD-55       | 071306 Required | N/A               |           | N/A          |             | N/A               |                  | N/A           |             |
|                | PD-110      |                 | N/A               |           | N/A          |             | 7" (178)          |                  | N/A           |             |
|                | PD-140      |                 | N/A               |           | N/A          |             | 7" (178)          |                  | N/A           |             |
|                | PD-200      |                 | N/A               |           | N/A          |             | 7" (178)          |                  | N/A           |             |

\* Indicates the pipe can be driven in certain applications. There is no guarantee expressed or implied by Rhino Tool that the driver will perform the needed task.

**⚠ WARNING - Chuck adapter size is important. A chuck adapter that is too large for the post being driven may cause the post driver to fall from the post, potentially causing serious injury to the operator or bystanders.**

# PD-55

**Pneumatic Post Driver**  
**Part No. 070013**



**Pneumatic • Hydraulic • Gasoline**  
**Professional Grade Tools**

The choice of professional installers for over 40 years, the Rhino PD-55 Pneumatic Post Driver is suited for driving t-posts, ground rod, tent stakes, grape stakes, delineator posts, form pins and fence posts up to 3 5/8".

- One moving part, a double valve, alloy steel, reciprocating piston, insures low-maintenance and longevity.
- Only 54 pounds and delivering up to 1700 blows per minute.
- Fits into tight jobsites, and only needs one operator.
- Additional driving options possible with easy bolt-in adapters.

| Specifications                             | PD-55          |
|--|----------------|
| Duty                                       | Medium         |
| Air Consumption CFM@90 psi (bar)           | 42 (6.2)       |
| Wt. lb (kg)                                | 54.6 (24.8)    |
| Ship Wt. lb (kg)                           | 60 (27.2)      |
| Master Chuck (mm)                          | 3-7/8" ID (98) |
| Applications                               |                |
| 3/4" to 1" Ground Rod                      | X•             |
| 3/4" to 1-1/2" Reinforcing Bar Tent Stakes | X•             |
| 1" Concrete Form Pins                      | X•             |
| 1" Pipe                                    | X•             |
| 1-1/4" to 1-1/2" Pipe                      | X•             |
| 1-5/8" Pipe                                | X•             |
| 2" Pipe                                    | X•             |
| 2-1/2"                                     | X•             |
| 3" Pipe                                    | X♦             |
| T Posts                                    | X•             |
| Telespar Posts                             | X•             |
| Telespar Post Breakaway Anchor 2-1/2"      | X♦♦            |
| 1.2 to 1.5 lbs/ft Channel Posts            | X•             |
| 2 to 2.75 lbs/ft Channel Posts             | X•             |
| 3 to 4 lbs/ft Channel Posts                | X•             |
| Channel Post Breakaway Anchor              | X♦♦            |
| C Posts                                    | X              |
| Rectangular Posts                          | X              |
| Fiberglass T Posts                         | X•             |

● An adapter is required ♦ A driving cap is required



A tradition of quality and service since 1975



Use your phone to scan the QR code found here and on your tool to quickly access the online owner's manual

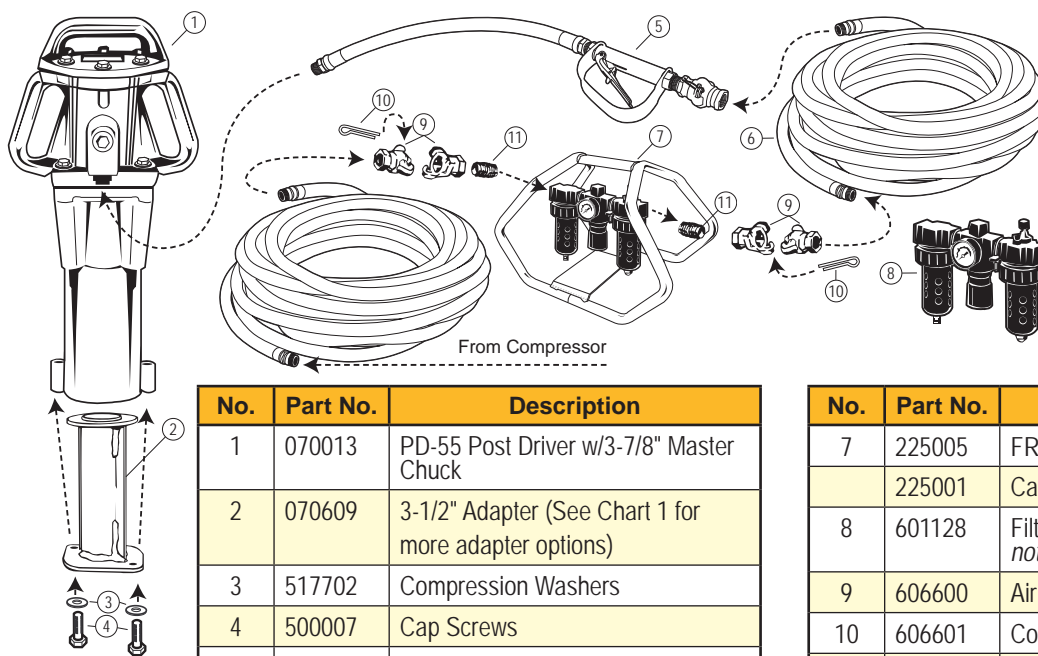

| No. | Part No. | Description   |
|-----|----------|---|
| 1   | 070013   | PD-55 Post Driver w/3-7/8" Master Chuck               |
| 2   | 070609   | 3-1/2" Adapter (See Chart 1 for more adapter options) |
| 3   | 517702   | Compression Washers                                   |
| 4   | 500007   | Cap Screws  |
| 5   | 600000   | Throttle Valve Kit with 5 ft. Hose                    |
| 6   | 607000   | Hose Assembly*  |

| No. | Part No. | Description  |
|-----|----------|--|
| 7   | 225005   | FRLand Carrier                                     |
|     | 225001   | Carrier for FRL (FRL not included)                 |
| 8   | 601128   | Filter-Regulator-Lubricator (Carrier not included) |
| 9   | 606600   | Air Line Coupler (Each)                            |
| 10  | 606601   | Coupler Safety Clip (limit 4 / order)              |
| 11  | 230401   | Nipple   |

\*Made to order length - additional charge per ft of hose

Chart 1

| PD-55 Adapters / Drive Caps / Master Chuck                  |          |
|---|----------|
| Description/Actual ID in (mm)                               | Part No. |
| 3 7/8" (98.4) Master Chuck                                  | 070592   |
| 4-1/4" (107.9) Optional Master Chuck (uses PD-110 Adapters) | 070060   |
| 4-1/16" (103.2) Square Wood Post Chuck                      | 070590   |
| 3-1/2" (88.9) Adapter                                       | 070609   |
| 3" (76.2) Adapter   | 070610   |
| 2-1/2" (63.5) Adapter                                       | 070611   |
| 2" (50.8) Adapter   | 070612   |
| 1-1/2" (38.1) Adapter                                       | 070613   |
| 1" (25.4) Adapter   | 070614   |
| 2" (50.8) Heavy for T-Post Adapter                          | 070615   |
| 1 to 1.5 lb/ft. Channel Adapter                             | 070617   |
| 2 to 2.75 lb/ft. Channel Adapter                            | 070618   |
| 3 to 4 lb/ft. Channel Adapter                               | 070619   |
| 2-1/2" (63.5) Drive Cap and T-bar                           | 071261   |
| 3" (76.2) Drive Cap and T-bar                               | 071262   |
| 3-1/2"(88.9) Drive Cap and T-bar                            | 071263   |

All adapters come with required hardware



PD-55 shown with Throttle Valve, Filter-Regulator-Lubricator (FRL) and Carrier.

#### Chuck adapters and part numbers

See Chart 1 for size information.



2", 3" and 3.5" Drive Cap Required for driving 2", 3" and 3.5" Pipe.



# PD-110

**Pneumatic Post Driver**  
Part No. 070014



**Pneumatic • Hydraulic • Gasoline**  
**Professional Grade Tools**

The Rhino PD-110 Pneumatic Post Driver has a slight advantage over the PD-55 in driving speed and tolerance of denser soil composition. The PD-110 takes post driving capabilities to the next level. It is suited for driving 2" to 4" pipe and tube, structural forms, pin piles, dock piles, and 4x4 wood.

- At 109 pounds, with an Alloy Steel piston, the PD-110 provides better handling in tough sites.
- Delivers up to 1000 blows per minute, and capable of driving a 2" O.D. post, ten to fifteen feet deep in most soil types.
- Can be lifted by two people, but a mechanical lift is recommended.
- Additional driving options possible with easy bolt-in adapters

| Specifications                        | PD-110            |
|---------------------------------------|-------------------|
| Duty                                  | Heavy             |
| Air Consumption CFM@100 psi (bar)     | 64 (6.9)          |
| Wt. lb (kg)                           | 109.16 (49.5)     |
| Ship Wt. lb (kg)                      | 117 (53)          |
| Master Chuck (mm)                     | 4 1/4" (107.9) ID |
| Applications                          |                   |
| 1-1/4" to 1-1/2" Pipe                 | X●                |
| 1-5/8" Round Post                     | X●                |
| 2" Pipe                               | X●                |
| 2-1/2" Pipe                           | X●                |
| 3" Pipe                               | X♦♦               |
| 3-1/2" Pipe                           | X♦                |
| 4" Pipe                               | X♦♦               |
| T-Posts                               | X●                |
| Telespar Post                         | X●                |
| Telespar Post Breakaway Anchor 2-1/2" | X♦♦               |
| 1.2 to 1.5 lbs/ft Channel Post        | X●                |
| 2 to 2.75 lbs/ft Channel Post         | X●                |
| 3 to 4 lbs/ft Channel Post            | X●                |
| Channel Post Breakaway Anchor         | X♦♦               |
| C Post                                | X                 |
| 4" x 4" Wood Post                     | X■                |

■ An additional master chuck is required    ● An adapter is required  
♦ A driving cap is required



*A tradition of quality and service since 1975*



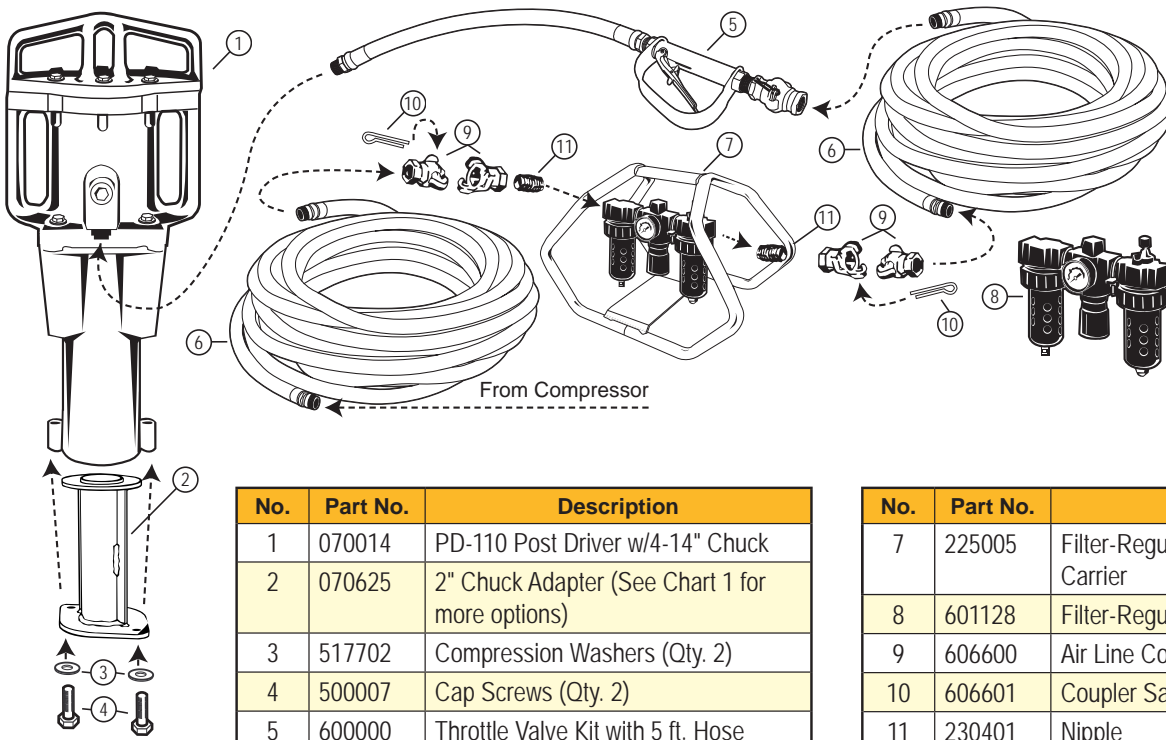

Use your phone to scan the QR code found here and on your tool to quickly access the online owner's manual

| No. | Part No. | Description                                     |
|-----|----------|---|
| 1   | 070014   | PD-110 Post Driver w/4-14" Chuck                |
| 2   | 070625   | 2" Chuck Adapter (See Chart 1 for more options) |
| 3   | 517702   | Compression Washers (Qty. 2)                    |
| 4   | 500007   | Cap Screws (Qty. 2)                             |
| 5   | 600000   | Throttle Valve Kit with 5 ft. Hose              |
| 6   | 607000   | Hose Assembly*                                  |

| No. | Part No. | Description                                   |
|-----|----------|---|
| 7   | 225005   | Filter-Regulator-Lubricator (FRL) and Carrier |
| 8   | 601128   | Filter-Regulator-Lubricator                   |
| 9   | 606600   | Air Line Coupler (each)                       |
| 10  | 606601   | Coupler Safety Clip (limit 4 per order)       |
| 11  | 230401   | Nipple  |

Made to order length - additional charge per ft of hose

Chart 1

| PD-110 Adapters / Drive Caps / Master Chucks |          |
|--|----------|
| Description/Actual ID-in (mm)                | Part No. |
| 4-1/4" (107.9) Master Chuck                  | 070593   |
| 3-5/8" (92) Adapter                          | 070622   |
| 3" (76.2) Adapter                            | 070623   |
| 2-1/2" (63.5) Adapter                        | 070624   |
| 2" (50.8) Adapter                            | 070625   |
| 1 to 1-1/2 lbs/ft Channel Post Adapter       | 070628   |
| 2 to 2.75 lbs/ft Channel Post Adapter        | 070629   |
| 3 to 4 lbs/ft Channel Post Adapter           | 070630   |
| 4-3/4" Master Chuck                          | 070644   |
| 3" Drive Cap and T-bar                       | 071262   |
| 3-1/2" Drive Cap and T-bar                   | 071263   |

All adapters come with required hardware



PD-110 shown with Throttle Valve Kit

### Bolt-in Chuck adapters and part numbers

See Chart 1 for size information.



3" and 3.5" Drive Cap Required for driving 3" and 3.5" Pipe.



# PD-140

**Pneumatic Post Driver**  
**Part No. 070015**



**Pneumatic • Hydraulic • Gasoline**  
**Professional Grade Tools**

The PD-140 is a Heavy-Duty Post Driver that has a weight-to-performance ratio unlike any other post driver. The PD-140 solidly drives guard rail posts, heavy line posts, corner posts, gate posts, baseball backstops, dock piles, pin piles, foundation piles, wood posts, concrete posts, heavy gauge aluminum posts, well points, well casings, and fence posts from 2" to 4" in diameter in a wide variety of soil conditions.

- At 139 pounds, with an Alloy Steel piston, the PD-140 drives large, heavy post quickly and securely.
- Delivering up to 900 blows per minute, and capable of driving guard rail and other heavy-duty posts.
- Low air consumption and high-quality components, mean low-cost, low-maintenance post driving
- Additional driving options possible with easy bolt-in adapters.



| Specifications                        | PD-140            |
|---------------------------------------|-------------------|
| Duty                                  | Heavy Duty        |
| Air Consumption CFM@100 psi (bar)     | 64 (6.9)          |
| Wt. lb (kg)                           | 138.4 (62.8)      |
| Ship Wt. lb (kg)                      | 149 (66.58)       |
| Master Chuck (mm)                     | 4-1/4" (107.9) ID |
| Applications                          |                   |
| 1-5/8" Round Post                     | X●                |
| 2" Pipe                               | X●                |
| 2-1/2" Pipe                           | X●                |
| 3" Pipe                               | X♦♦               |
| 3-1/2" Pipe                           | X♦                |
| 4" Pipe                               | X♦♦               |
| T-Posts                               | X♦♦               |
| Telespar Post                         | X●                |
| Telespar Post Breakaway Anchor 2-1/2" | X♦♦               |
| Telespar Post Breakaway Anchor 3"     | X♦♦               |
| 1.2 to 1.5 lbs/ft Channel Post        | X●                |
| 2 to 2.75 lbs/ft Channel Post         | X●                |
| 3 to 4 lbs/ft Channel Post            | X●                |
| Channel Post Breakaway Anchor         | X♦♦               |
| C Post                                | X                 |
| Super C Post                          | X                 |
| Well Points (Sand Points)             | X                 |
| 4" x 4" Wood Post                     | X■                |
| 4" x 6" H Column Guardrail Post       | X♦♦               |
| 12" Sheet Piling                      | X■                |

■ An optional master chuck is required    ● An adapter is required  
♦ A driving cap is required



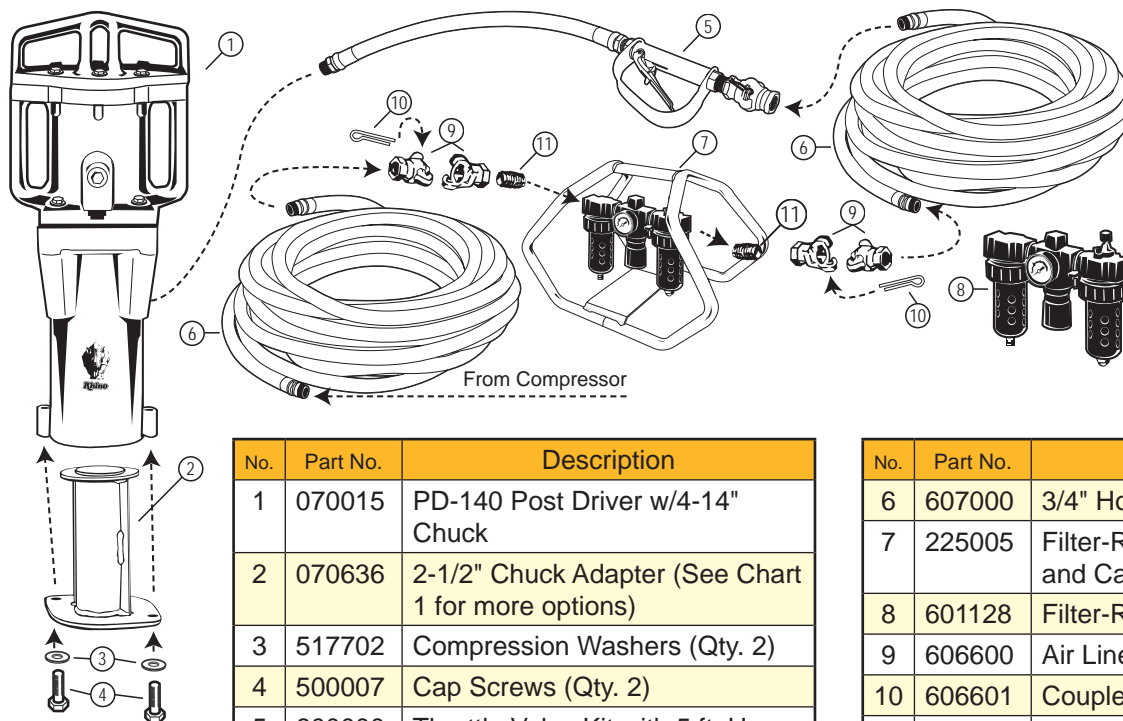

Use your phone to scan the QR code found here and on your tool to quickly access the online owner's manual

Made to order length - additional charge per ft of hose

Chart 1

| PD-140 Adapters / Drive Caps / Master Chucks                 |          |
|--|----------|
| Description/Actual ID-in (mm)                                | Part No. |
| 4-1/4" (107.9) Master Chuck                                  | 070594   |
| 3-5/8" (92) Adapter  | 070634   |
| 3" (76.2) Adapter  | 070635   |
| 2-1/2" (63.5) Adapter  | 070636   |
| 2" (50.8) Adapter  | 070637   |
| 1 to 1-1/2 lbs/ft Channel Post Adpt                          | 070640   |
| 2 to 2.75 lbs/ft Channel Post Adpt                           | 070641   |
| 3 to 4 lbs/ft Channel Post Adpt                              | 070642   |
| 4"x4" Square for Wood  | 070063   |
| Slotted Sheet Pile Master Chuck                              | 070597   |
| 4-3/4 Master Chuck   | 070644   |
| 4"x6" Master Chuck H Column Guardrail (070062 also required) | 070061   |
| 4 x 6 H Column Drive Cap                                     | 070062   |
| 3" Drive Cap and T-bar                                       | 071262   |
| 3-1/2" Drive Cap and T-bar                                   | 071263   |

All adapters come with required hardware.  
Special Order adapters, chucks and drive caps available - call for quote



PD-140 shown with Throttle Valve, Filter-Regulator-Lubricator (FRL) and Carrier.

3" and 3.5" Drive Cap Required for driving 3" and 3.5" Pipe.



#### Chuck adapters and part numbers

See Chart 1 for size information.





# PD-200

## Pneumatic Post Driver

Part No. 070756 - 7" chuck

Part No. 070745 - 5" chuck



Pneumatic • Hydraulic • Gasoline  
Professional Grade Tools

The PD-200 Heavy Duty Post Pounder is the perfect choice for driving Beams, Round, Square or Rectangular Tubing, Wood Posts, and Stakes of any shape. Capable of outperforming a 90 lb. Jack Hammer, the PD-200 features an Alloy Steel piston and 5-1/2" or 7" Master Chuck.

- At 170 pounds, the PD-200 drives large, heavy post quickly and securely.
- Delivering up to 900 blows per minute, and capable of driving guardrail and other heavy-duty posts.

| Specifications                        | PD-200                 | PD-200               |
|---------------------------------------|------------------------|----------------------|
| Duty                                  | Heavy Duty             | Heavy Duty           |
| Air Consumption CFM@100 psi (bar)     | 72 (6.9)               | 72 (6.9)             |
| Wt. lb (kg)                           | 170 (77.11)            | 177 (80.28)          |
| Ship Wt. lb (kg)                      | 175 (79.37)            | 182 (82.55)          |
| Master Chuck                          | 5-1/2"<br>(139.7mm) ID | 7"<br>(177.8mm) I.D. |
| Applications                          |                        |                      |
| 2" Pipe                               | X●                     | X●                   |
| 2-1/2" Pipe                           | X●                     | X●                   |
| 3" Pipe                               | X◆                     | X◆                   |
| 3-1/2" Pipe                           | X◆                     | X◆                   |
| 4" Pipe                               | X◆                     | X◆                   |
| 5" to 6" Pipe                         |                        | X◆                   |
| Telespar Post                         | X●                     | X●                   |
| Telespar Post Breakaway Anchor 2-1/2" | X◆                     | X◆                   |
| Telespar Post Breakaway Anchor 3"     | X◆                     | X◆                   |
| C Post                                | X●                     | X●                   |
| Super C Post                          | X●                     | X●                   |
| Well Points (Sand Points)             | X●                     | X●                   |
| 4" x 4" Wood Post                     | X                      | X●                   |
| 4" x 6" H Column Guardrail Post       | X◆                     | X◆                   |
| 6" x 6" Wood Posts                    | X■                     | X■                   |
| Seawall Sheet Piling                  | X■                     | X■                   |

■ An optional master chuck is required ● An adapter is required

◆ A driving cap is required



5 1/2 in (139.7)  
Master Chuck included with driver.

7 in (177.8)  
Master Chuck included with driver.

- Low air consumption and high-quality components, mean low-cost, low-maintenance post driving
- Additional driving options possible with easy bolt-in adapters.



A tradition of quality and service since 1975



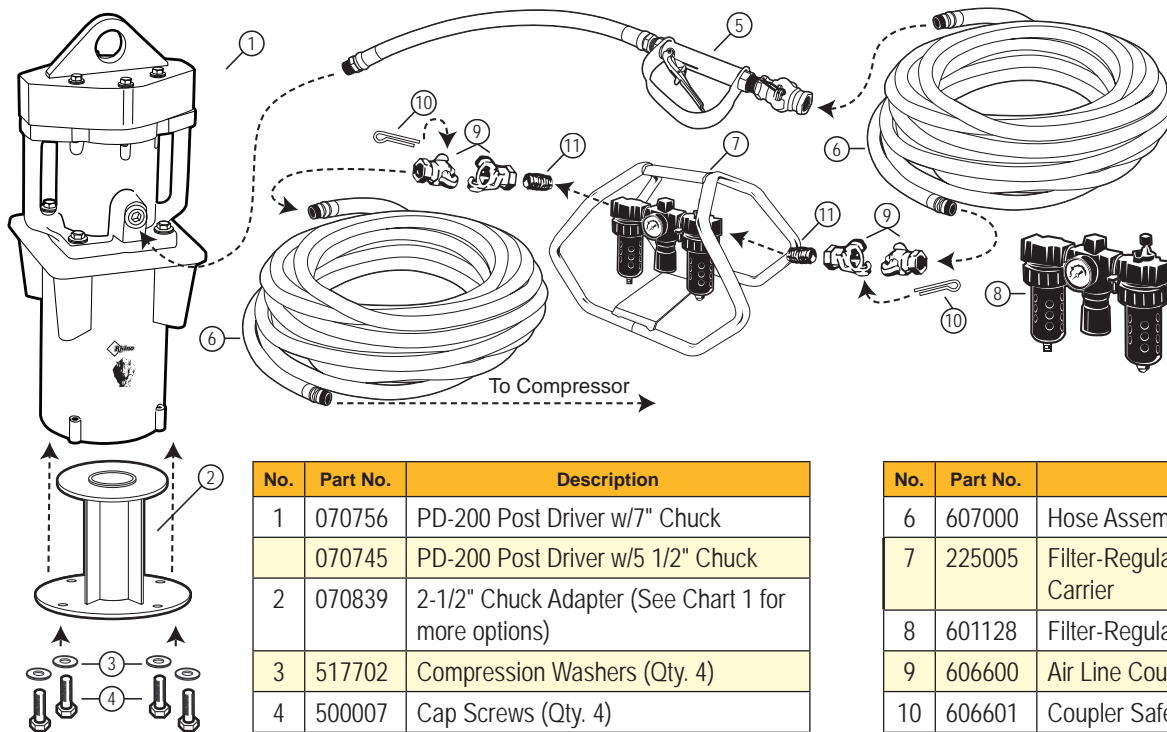

Use your phone to scan the QR code found here and on your tool to quickly access the online owner's manual

| No. | Part No. | Description   |
|-----|----------|---|
| 1   | 070756   | PD-200 Post Driver w/7" Chuck                       |
|     | 070745   | PD-200 Post Driver w/5 1/2" Chuck                   |
| 2   | 070839   | 2-1/2" Chuck Adapter (See Chart 1 for more options) |
| 3   | 517702   | Compression Washers (Qty. 4)                        |
| 4   | 500007   | Cap Screws (Qty. 4)                                 |
| 5   | 600000   | Throttle Valve Kit                                  |

| No. | Part No. | Description                                   |
|-----|----------|---|
| 6   | 607000   | Hose Assembly                                 |
| 7   | 225005   | Filter-Regulator-Lubricator (FRL) and Carrier |
| 8   | 601128   | Filter-Regulator-Lubricator                   |
| 9   | 606600   | Air Line Coupler                              |
| 10  | 606601   | Coupler Safety Clip (limit 4 per order)       |
| 11  | 230401   | 3/4" Close Nipple                             |

Made to order length - additional charge per ft of hose

Chart 1

| Chuck/Adapter/Drive Cap                                      | PD-200 (5-1/2") | PD-200 (7") |
|--|-----------------|-------------|
| Description/Actual ID-in (mm)                                | Part No.        | Part No.    |
| 7" (177.8) Master Chuck                                      |                 | 070758      |
| 5-1/2" (139.7) Master Chuck                                  |                 | 070746      |
| Slotted Sheet Pile Master Chuck                              | 070597          | 070597      |
| 4-3/4" Master Chuck  | 070644          | 070644      |
| 4"x6" Master Chuck H Column Guardrail (070062 also required) | 070061          | 070061      |
| 4" x 6" Drive Cap  | 070062          | 070062      |
| 6"x6" Square Master Chuck                                    | 070761          | 070761      |
| 5-3/4" (146) Adapter   |                 | 070791      |
| 5-1/4" (133.4) Adapter                                       |                 | 070790      |
| 5" (133.4) Adapter   |                 | 070837      |
| 4-3/4" (120.6) Adapter                                       | 070785          | 070789      |
| 4-1/4" (107.9) Adapter                                       | 070784          | 070788      |
| 3-3/4" (95.3) Adapter  | 070783          | 070787      |
| 3-1/8" (79.4) Adapter  | 070782          | 070786      |
| 2-1/2" (63.5) Adapter  | 070842          | 070839      |
| 4"x4" Square   | Master Chuck    | 070837      |

All adapters come with required hardware.  
Special Order adapters, chucks and drive caps available - call for quote

**Chuck adapters and part numbers**  
See Chart 1 for size information.



PD-200 shown with Throttle Valve, Filter-Regulator-Lubricator (FRL) and Carrier.



3" to 6" Drive Cap Required for driving 3" to 6" Pipe.



# PD-140S

## Pneumatic Sheet Pile Driver

Part No. 070017 - Model PD140 with Heavy Duty Sheet Pile Chuck



Pneumatic • Hydraulic • Gasoline  
Professional Grade Tools

The PD-140S is the modified version of the PD-140 with the added flexibility to drive sheet piling. While capable of driving everything the PD-140 is capable of driving, the PD-140S has been fitted with a slotted master chuck which allows the sheet pile to pass through the chuck to engage the piston.

- At 139 pounds, with an Alloy Steel piston, the PD-140S drives sheet pile for retaining soil or water.
- Delivering up to 900 blows per minute combined with low air consumption and high-quality components, mean low-cost, low-maintenance post driving
- Additional driving options possible with easy bolt-in adapters.



| Specifications                    | PD-140               |
|-----------------------------------|----------------------|
| Duty                              | Heavy Duty           |
| Air Consumption CFM@100 psi (bar) | 64 (6.9)             |
| Wt. lb (kg)                       | 138.4 (62.8)         |
| Ship Wt. lb (kg)                  | 149 (66.58)          |
| Master Chuck                      | 4-1/4"<br>(107.9) ID |
| Applications                      |                      |
| Sheet Piling / Seawall            |                      |



PD-140S driving Truline Vinyl Sheet Pile®



Driver shown with sheet pile inserted into chuck.

Visit [rhinotool.com](http://rhinotool.com) for additional adapters and accessories for the PD-140 to see other driving options.



*A tradition of quality and service since 1975*

# PD-200S

## Pneumatic Sheet Pile Driver

Part No. 070753 - Model PD200 with Heavy Duty Sheet Pile Chuck



Pneumatic • Hydraulic • Gasoline  
Professional Grade Tools



070597  
Slotted Sheet Pile Chuck  
included with driver.

Additional Chucks and Bolt-on adapters for the PD200 sold separately.

The PD-200S is capable of driving everything the PD-200 is capable of driving, but the PD-200S has been fitted with a PD140 slotted master chuck which allows the sheet pile to pass through the chuck to engage the piston. The sheet pile chuck is replaceable to allow larger PD-200 chucks to be bolted-on making the post driver capable of wooden pile or guardrail post installations. Guardrail and wooden post chucks can be purchased separately.

- At 170 pounds, with a 4" Alloy Steel piston, the PD-200S drives sheet pile quickly and easily.
- Delivering up to approximately 930 blows per minute, and capable of driving guardrail and other heavy-duty posts with the change of a chuck.
- Low air consumption and high-quality components, provide low-cost, low-maintenance post driving

| Specifications                    | PD-200S           |
|-----------------------------------|-------------------|
| Duty                              | Heavy Duty        |
| Air Consumption CFM@100 psi (bar) | 72 (6.9)          |
| Wt. lb (kg)                       | 170 (77)          |
| Ship Wt. lb (kg)                  | 172 (78)          |
| Master Chuck                      | 4-1/4" (107.9) ID |
| Applications                      |                   |
| 12" Sheet Piling                  |                   |



Driver shown with sheet pile  
inserted into chuck.



*A tradition of quality and service since 1975*



# PD-200G

**Pneumatic Guardrail Driver**

**Part No. 070583 - Model PD200 with Guardrail Chuck**



**Pneumatic • Hydraulic • Gasoline**  
**Professional Grade Tools**



070062 Drive Cap



070062 Drive Cap

## Install Guardrail FAST!

Rhino® PD-200G Guardrail Post Driver is ideal for 4"x6" guardrail posts.

The Rhino PD-200G™ is the perfect choice for heavy duty applications for driving wood or steel guardrail posts quickly and safely. Optional master chucks and adapters are available for other post driving applications beyond guardrail.

- Works with Steel or Wood Posts
- Low air consumption - 72 cfm @ 100 psi
- At 175 lbs, the compact profile fits challenging jobsites.



The PD-200G is Perfect for Wood or Steel Guardrail Posts



Additional Filter-Regulator - Lubricator recommended with the PD-200G increases tool-life.

| Specifications                      | PD-200G          |
|-------------------------------------|------------------|
| Duty                                | Heavy Duty       |
| Air Consumption CFM@100 psi (bar)   | 72 (6.9)         |
| Wt. lb (kg)                         | 170 (77.11)      |
| Ship Wt. lb (kg)                    | 175 (79.37)      |
| Master Chuck                        | 4" (101.6mm) ID  |
| Application/Chuck/Adapter/Drive Cap | PD-200G/Part No. |
| 4" x 6" H Column Guardrail Post     | 070061           |
| Drive Cap                           | 070062           |

*All adapters come with required hardware. Special Order adapters available - call for quote*



*A tradition of quality and service since 1975*



# PD-200

## Pneumatic Pile Driving Kit

Part Number 071400



Pneumatic • Hydraulic • Gasoline  
Professional Grade Tools

Perfect for dock, decks, sheet pile and seawall installations, the PD-200 Pile Driving Kit keeps everything together in a rugged, steel toolbox with a place for each accessory. At 170 lbs, the PD-200 Post Driver drives large, heavy posts quickly and securely. Easy operation, low maintenance, and extreme durability make this a great return on investment. Kit comes with items 1-7 shown below. Part No. 071400 - Ship Wt. 540 lbs.

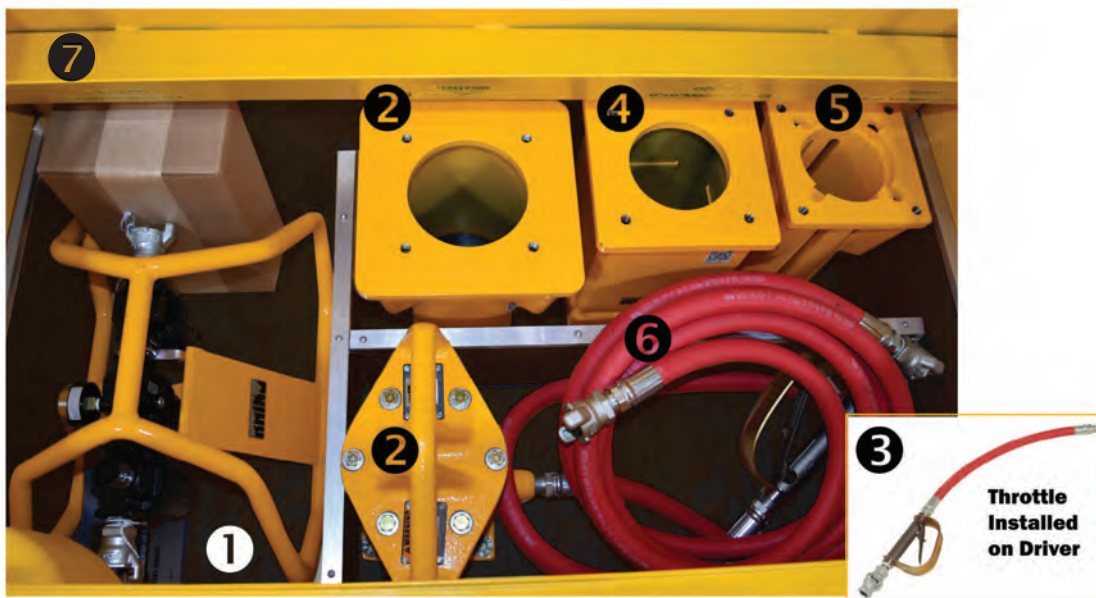

1. Carrier w/Filter-Regulator-Lubricator (FRL) Installed P/N 225005
2. PD-200 Post Driver with 7" Master Chuck P/N 070756
3. Throttle Valve Kit with Screen Fitting and 5' hose P/N 600000

4. PD-200 6" x 6" Master Chuck Assembly P/N 070761
5. PD-140/200 Slotted Master Chuck Assembly P/N 070597
6. Air Hose 15'-2" P/N 071199
7. Steel Tool Box for storage P/N 071401

### DOCK PILE DRIVER

### SHEET PILE DRIVER

### SQUARE WOOD PILE

**1 KIT =  
3 Pile  
Driving  
OPTIONS**



070758  
7" Master  
Chuck  
included on  
driver



070597  
Slotted  
Sheet Pile  
Chuck



070761  
6" x 6"  
Master Chuck  
Drives 6" x 6"  
Wood Post

Quick Chuck change instructions on box make switching the Master Chuck Easy

## Heavy Duty 48" Toolbox included with kit

- Locking arms on lid prevent accidental closure.
- Recessed area to add additional security locks.
- All steel construction with fully welded seams for durability.
- Weather resistant powder-coat paint.
- PD-200 Kit Contents and chuck install instructions shown on inside of lid to help prevent lost parts.

## Specifications and Included Parts

|        |  |
|--------|--|
|        | Ship Wt. 540 lbs (245 kg)                                |
|        | Dimensions (W x D x H) 48" x 24" x 27-1/2"               |
| 070756 | PD-200 Post Driver with 7" I.D. Master Chuck             |
|        | Air Consumption (72 CFM@100 psi)                         |
| 225005 | Carrier with Filter-Regulator-Lubricator (FRL) installed |
| 600000 | Throttle Valve Kit with Screen Fitting and 5' hose       |
| 070761 | PD-200 6" x 6" Master Chuck Assembly                     |
| 070597 | PD-140/200 Slotted Master Chuck Assembly                 |
| 071199 | Air Hose 15'-2" with 3/4" MNPT Fittings & Quick Connects |
| 071401 | Steel Tool Box for storage                               |



## Applications

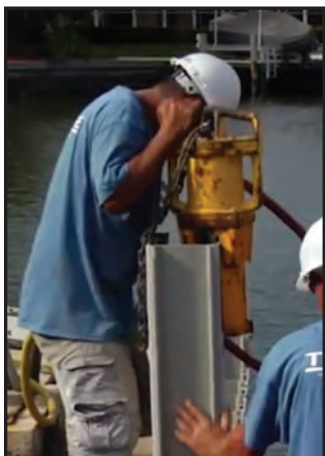

Slotted Master Chuck (P/N 070597) Attached for driving sheet pile.



Driver shown with sheet pile inserted into chuck.



7" Master Chuck (P/N 070756) Driving Steel Post



6" x 6" Master Chuck (P/N 070761) Attached for square wood pile.



Scan to go to PD-200 information online  
or call 866-707-1808



*A tradition of quality and service since 1975*





# Accessories

For Rhino Pneumatic Post Drivers



Pneumatic • Hydraulic • Gasoline  
Professional Grade Tools

## Pneumatic Driver Transport, Hose and Throttle Valve

|   | Description   | PDT-55 | PDT-110 | PDT-140 |
|---|---|--------|---------|---------|
|    | <b>Transport Cart Only</b><br>Includes: cart, handle, wheels, axle, hardware, brackets for specified model, oil bottle holder, 1 qt. 10W Non-Detergent Oil, transport manual, and extra bolts/washers.  | 071201 | 071202  | 071203  |
|   | <b>Transport Kit - Complete</b><br>Includes: Post driver, 4 adapters, hose whip, throttle valve, Filter-Regular-Lubricator, cart, handle, wheels, axle, hardware, brackets for specified model, oil bottle holder, 1 qt. 10W Non-Detergent Oil, transport manual, 15' 2" hose and extra bolts/washers.  | 071216 | 071217  | 071218  |
|  | <b>Transport Kit - Total Solution</b><br>Includes: Post driver, 4 adapters, hose whip, throttle valve, Filter-Regular-Lubricator, cart, handle, wheels, axle, hardware, brackets for specified model, oil bottle holder, 1 qt. 10W Non-Detergent Oil, transport manual, 15' 2" hose, extra bolts/washers - plus MP-3 manual post puller, chain assembly and post grabber. | 071269 | 071270  | 071271  |
|  | 3/4" Hose Assembly (parts and labor only)<br>Does not include hose  | 607000 |         |         |
|   | Throttle Valve Kit with 5' (1.524 meters) Hose Whip   | 600000 |         |         |
|   | Extra 3/4" Air Hose (Must order by the foot)  | 605006 |         |         |
|   | Throttle Valve Only with lever guard  | 610026 |         |         |



# Accessories

## Pneumatic Drive Caps and Filter-Regulator-Lubricator

| Filter-Regulator-Lubricator   | Description                                      | PD-55  | PD-110 | PD-140 | PD-140 |
|---|--|--------|--------|--------|--------|
|  | Filter-Regulator-Lubricator with Carrier and FRL | 225005 |        |        |        |
|   | Filter-Regulator-Lubricator Only*                | 601128 |        |        |        |
|   | F.R.L. Carrier Only                              | 225001 |        |        |        |

\*The F.R.L. or Filter-Regulator-Lubricator is recommended for all pneumatic post drivers for operator safety and post driver protection.







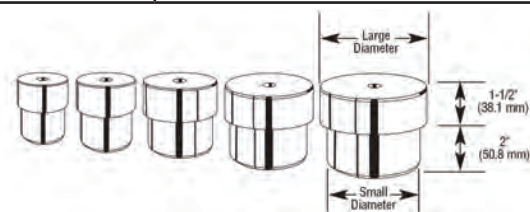

**Drive Caps are for Schedule 40 Pipe - Please call Rhino at 866-707-1808 to order for Schedule 80 pipe.**

| Drive Cap  | Size   | Part Number | Drive Cap Tool*                  | Height (mm)    | Large Diameter (mm) | Small Diameter (mm) |
|--|--------|-------------|----------------------------------|----------------|---------------------|---------------------|
|   | 2"     | 071260      | T-Bar (071265) and Clip (071266) | 3 1/2" (88.9)  | 2 3/8" (60.325)     | 2.04" (50.84)       |
|  | 2 1/2" | 071261      |                                  | 3 1/2" (88.9)  | 2 7/8" (73.025)     | 2.45" (176.4)       |
|  | 3"     | 071262      |                                  | 3 1/2" (88.9)  | 3 1/2" (88.9)       | 3.05" (77.47)       |
|  | 3 1/2" | 071263      | Slammer Hammer (071330)          | 3 1/2" (88.9)  | 4" (101.6)          | 3.53" (89.662)      |
|  | 4"     | 071264      |                                  | 3 1/2" (88.9)  | 4 1/2" (114.3)      | 4" (101.6)          |
|  | 5"     | 071295      |                                  | 3 1/2" (88.9)  | 5 1/2" (141.3)      | 5" (127)            |
|  | 6"     | 071306      |                                  | 5 1/2" (139.7) | 6 5/8" (168.3)      | 6.20" (157.5)       |

\*Drive cap tool included with drive cap - tool screws into hole at top of drive cap to provide a way to release the drive cap if stuck in pipe.



## Low Drive Extension Drive Caps and Adapters for Square Tube Break-Away Anchors

| Drive Cap   | Part No. | Size  | Description   | PD-55   | PD-110  | PD-140  |  |  |  |
|---|----------|-------|---|---|---|---|--|--|--|
|  | 071004   | 1¼ "  | Low Drive Extension Drive Caps - drive square tube break-away anchors within 2 inches of ground level. Drives up to a 2 1/2" square anchor. | <br>Chuck Adapter for Drive Cap (071014) | <br>Chuck Adapter for Drive Cap (071017) | <br>Chuck Adapter for Drive Cap (071015) |  |  |  |
|  | 071005   | 1½ "  |   |   |   |   |  |  |  |
|  | 071006   | 1 ¾ " |   |   |   |   |  |  |  |
|  | 071007   | 2 "   | Please note: Anchor Drive caps are measured by the outside dimension of the anchor.   |   |   |   |  |  |  |
|  | 071008   | 2¼ "  |   |   |   |   |  |  |  |
|  | 071009   | 2½ "  |   |   |   |   |  |  |  |



# Pneumatic Post Driver Accessories

For driving square tube and channel post



Pneumatic • Hydraulic • Gasoline  
Professional Grade Tools

For installing Square Tube or Channel Post for Traffic Safety Signs, the add-on chucks, adapters and drive caps below can each be ordered separately to fit the size and type of post you are installing. Please contact a Rhino representative if you have any questions about these systems.

## Square Tube Break-Away Anchor System

Drives Square Anchors within 2 inches of ground level.  
Will drive up to a 2 1/2" square anchor\*\*

### Adapter Part Numbers:

071014 PD-55 Chuck Adapter  
071017 PD-110 Chuck Adapter  
071015 PD-140 Chuck Adapter  
071043 PD-200 (5 1/2" MC) Chuck Adapter

### Drive Cap Part Numbers for use with above adapter:

071004 1 1/4" Drive Cap for the Square Tube Break-Away  
071005 1 1/2" Drive Cap for the Square Tube Break-Away  
071006 1 3/4" Drive Cap for the Square Tube Break-Away  
071007 2" Drive Cap for the Square Tube Break-Away  
071008 2 1/4" Drive Cap for the Square Tube Break-Away  
071009 2 1/2" Drive Cap for the Square Tube Break-Away

*\*\*Anchor Drive Caps are sold by the outside dimension of the anchor.*

Shown Left to Right:  
Post Driver - Adapter - Drive Cap - Square Tube

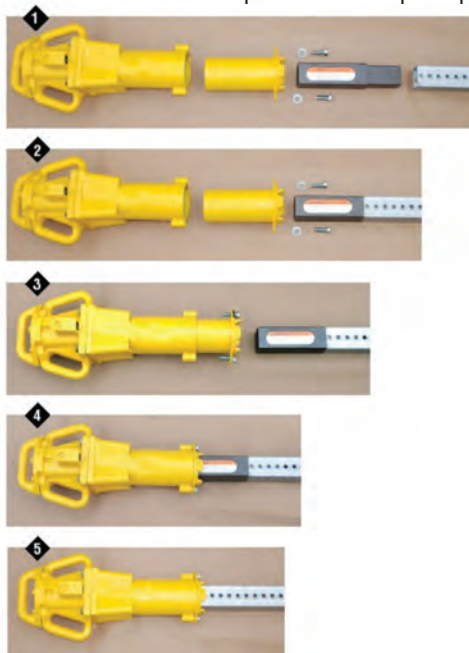

Drives Anchor 2 inches above ground

## Channel Post Break-Away Anchor System

Drives Channel Post Anchors within 2 inches of ground level. Will drive up to a 4 lb/ft Channel Post Anchor.

### Adapter Part Numbers:

070832 PD-55 Chuck Adapter  
070847 PD-110 Chuck Adapter  
070874 PD-140 Chuck Adapter  
071039 PD-200 (5 1/2" MC) Chuck Adapter

### Drive Cap Part Numbers for use with above adapter:

070836 Drive Cap for the Channel Post Break-Away Anchor

This Adapter and Drive Cap is to be used for anchors only. The drive cap can present a safety hazard as the drive cap is not attached to the driver or adapter and can fall and cause injury.

*PD 55 Post Driver, Drive Cap, and adapters shown are sold separately*

Shown Left to Right:  
Post Driver - Adapter - Drive Cap - Channel

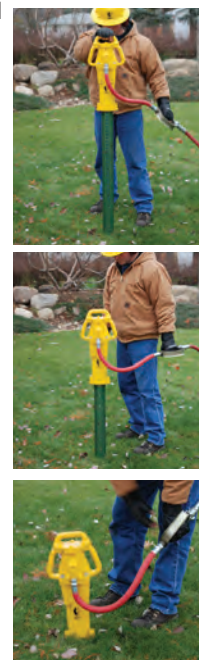

Drives Anchor 2 inches above ground

# Utility Kits

Ready-to-go post driver and accessory combinations  
for utility crews to easily fit on their work trucks



Pneumatic • Hydraulic • Gasoline  
Professional Grade Tools

## PD 55 Kits

| PD 55 Utility Kit             |  | PD 55 Fence Post Kit           |  |
|-------------------------------|--|--------------------------------|--|
| 071277                        | PD 55 Utility Kit is designed to outfit a utility vehicle with the essential elements to allow crews to disembark a vehicle and perform required tasks quickly and efficiently. This kit includes the following: | 071341                         | PD 55 Fence Post Driver Kit contains the basic pieces needed to begin driving in round fence post under 2.5" in diameter. This kit includes the following: |
| 70013                         | One (1) PD 55 Medium Duty Post   | 070013                         | One (1) PD 55 Medium Duty Post Driver  |
| Choice                        | One (1) PD 55 Chuck Adapter (size specified by customer)   | 070611                         | One (1) PD 55 2.5" I.D. Chuck Adapter  |
| 600000                        | Throttle Valve Kit with 5' 9" Hose Whip  | 600000                         | Throttle Valve Kit with 5' 9" Hose Whip  |
| 225005                        | One (1) Filter-Regulator-Lubricator & Carrier  | 225005                         | One (1) Filter-Regulator-Lubricator & Carrier  |
| 071199                        | One (1) 15'2" Hose Whip with Quick Connect Fittings  | 071199                         | One (1) 15'2" Hose Whip with Quick Connect Fittings  |
| 71012                         | MP 3 Manual Post Puller with chain assembly/grabber - 220422/71040   |                                |  |
| PD 55 Square Post Driver Kits |  | PD 55 Channel Post Driver Kits |  |
| 071342                        | PD 55 Square Post Driver Kit contains the basic pieces needed to begin driving in break-away, square tube. This kit includes the following:  | 071343                         | PD 55 Channel Post Driver Kit contains the basic pieces needed to begin driving in channel post. This kit includes the following:                          |
| 70013                         | One (1) PD 55 Medium Duty Post   | 070013                         | One (1) PD 55 Medium Duty Post Driver  |
| 71014                         | One (1) PD 55 Square Tube Break-Away Adapter   | 070832                         | One (1) PD 55 Channel Post Adapter   |
| 600000                        | Throttle Valve Kit with 5' 9" Hose Whip  | 600000                         | Throttle Valve Kit with 5' 9" Hose Whip  |
| 225005                        | One (1) Filter-Regulator-Lubricator & Carrier  | 225005                         | One (1) Filter-Regulator-Lubricator & Carrier  |
| 071199                        | One (1) 15'2" Hose Whip with Quick Connect Fittings  | 071199                         | One (1) 15'2" Hose Whip with Quick Connect Fittings  |
| 071007                        | 2" Drive Cap for the Square Tube Break-Away System   | 070836                         | Drive Cap for the Channel Post Break-Away Anchor System  |

## PD 110 Kits

| PD 110 Utility Kit |   | PD 110 Fence Post Kit |   |
|--------------------|---|-----------------------|---|
| 071278             | PD 110 Utility Kit is designed to outfit a utility vehicle with the essential elements to allow crews to disembark a vehicle and perform required tasks quickly and efficiently. This kit includes the following: | 071344                | PD 110 Fence Post Driver Kit contains the basic pieces needed to begin driving in round fence post under 2.5" in diameter. This kit includes the following: |
| 70013              | One (1) PD 110 Medium Duty Post   | 070013                | One (1) PD 110 Medium Duty Post Driver  |
| Choice             | One (1) PD 110 Chuck Adapter (size specified by customer)   | 070611                | One (1) PD 110 2.5" I.D. Chuck Adapter  |
| 600000             | Throttle Valve Kit with 5' 9" Hose Whip   | 600000                | Throttle Valve Kit with 5' 9" Hose Whip   |
| 225005             | One (1) Filter-Regulator-Lubricator & Carrier   | 225005                | One (1) Filter-Regulator-Lubricator & Carrier   |
| 071199             | One (1) 15'2" Hose Whip with 3/4" Quick Connects  | 071199                | One (1) 15'2" Hose Whip with 3/4" Quick Connects  |
| 71012              | MP 3 Manual Post Puller with chain assembly/grabber - 220422/71040  |                       |   |

## PD 140 Kits

| PD 140 Utility Kit |   |            | PD 140 Fence Post Kit |   |            |
|--------------------|---|------------|-----------------------|---|------------|
| 071279             | PD 140 Utility Kit is designed to outfit a utility vehicle with the essential elements to allow crews to disembark a vehicle and perform required tasks quickly and efficiently. This kit includes the following: | \$5,597.00 | 071345                | PD 140 Fence Post Driver Kit contains the basic pieces needed to begin driving in round fence post under 2.5" in diameter. This kit includes the following: | \$4,739.60 |
| 070015             | One (1) PD 140 Heavy Duty Post  |            | 070015                | One (1) PD 140 Heavy Duty Post Driver   |            |
| Choice             | One (1) PD 140 Chuck Adapter (size specified by customer)   |            | 070635                | One (1) PD 140 3" I.D. Chuck Adapter  |            |
| 600000             | Throttle Valve Kit with 5' 9" Hose Whip   |            | 600000                | Throttle Valve Kit with 5' 9" Hose Whip   |            |
| 225005             | One (1) Filter-Regulator-Lubricator & Carrier   |            | 225005                | One (1) Filter-Regulator-Lubricator & Carrier   |            |
| 071199             | One (1) 15'2" Hose Whip with 3/4" Quick Connect Fittings  |            | 071199                | One (1) 15'2" Hose Whip with 3/4" Quick Connect Fittings  |            |
| 71012              | MP 3 Manual Post Puller with chain assembly/grabber -   |            |                       |   |            |
|                    | 220422/71040  |            |                       |   |            |

## PD 200 Kits

| PD 200 with 5 1/2" Master Chuck Utility Kit |   |            | PD 200 with 5 1/2" Master Chuck Economy Kit |   |            |
|---|---|------------|---|---|------------|
| 071331                                      | PD 200 Utility Kit is designed to outfit a utility vehicle with the essential elements to allow crews to disembark a vehicle and perform required tasks quickly and efficiently. This kit includes the following: | \$6,467.00 | 071297                                      | PD 200 Fence Post Driver Kit contains the basic pieces needed to begin driving in round fence post under 2.5" in diameter. This kit includes the following: | \$5,330.00 |
| <u>070745</u>                               | One (1) PD 200 w/ 5 1/2" Master Chuck   |            | <u>070745</u>                               | One (1) PD 200 w/ 5 1/2" Master Chuck   |            |
| Choice                                      | One (1) PD 200 Chuck Adapter (size specified by customer)   |            | Choice                                      | One (1) PD 200 Chuck Adapter (size specified by customer)   |            |
| 600000                                      | Throttle Valve Kit with 5' 9" Hose Whip   |            | 600000                                      | Throttle Valve Kit with 5' 9" Hose Whip   |            |
| 225005                                      | One (1) Filter-Regulator-Lubricator & Carrier   |            | 225005                                      | One (1) Filter-Regulator-Lubricator & Carrier   |            |
| 071199                                      | One (1) 15'2" Hose Whip with 3/4" Quick Connects  |            | 071199                                      | One (1) 15'2" Hose Whip with 3/4" Quick Connects  |            |
| 71012                                       | MP 3 Manual Post Puller with chain assembly/grabber -   |            |   |   |            |
|   | 220422/71040  |            |   |   |            |
|   |   |            |   |   |            |
| PD 200 with 7" Master Chuck Utility Kit     |   |            | PD 200 with 7" Master Chuck Economy Kit     |   |            |
| 071332                                      | PD 200 Utility Kit is designed to outfit a utility vehicle with the essential elements to allow crews to disembark a vehicle and perform required tasks quickly and efficiently. This kit includes the following: | \$8,000.00 | 071298                                      | PD 200 Economy Kit contains the basic pieces needed to begin driving in round fence post under 5 1/2" in diameter. This kit includes the following:         | \$5,675.00 |
| 070756                                      | One (1) PD 200 w/7" Master Chuck  |            | 070756                                      | One (1) PD 200 w/7" Master Chuck  |            |
| Choice                                      | One (1) PD 200 Chuck Adapter (size specified by customer)   |            | Choice                                      | One (1) PD 200 Chuck Adapter (size specified by customer)   |            |
| 600000                                      | Throttle Valve Kit with 5' 9" Hose Whip   |            | 600000                                      | Throttle Valve Kit with 5' 9" Hose Whip   |            |
| 225005                                      | One (1) Filter-Regulator-Lubricator & Carrier   |            | 225005                                      | One (1) Filter-Regulator-Lubricator & Carrier   |            |
| 071199                                      | One (1) 15'2" Hose Whip with 3/4" Quick Connects  |            | 071199                                      | One (1) 15'2" Hose Whip with 3/4" Quick Connects  |            |
| 071012                                      | MP 3 Manual Post Puller   |            |   |   |            |



A tradition of quality and service since 1975





# Adapter Profile and Chuck Sizing Guide

For Approximate Inside Dimensions of  
Pneumatic Post Driver Chuck Adapters

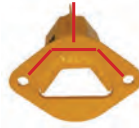

Pneumatic • Hydraulic • Gasoline  
Professional Grade Tools

## ADAPTER PROFILES - Chart 1

| MODELS                     |  |  |  |  |  |
|----------------------------|---|---|---|---|--|
| <b>PD55</b>                | 070617  | 070618  | 070619  | 070832  | 071014   |
| <b>PD110</b>               | 070628  | 070629  | 070630  | 070847  | 071017   |
| <b>PD140</b>               | 070640  | 070641  | 070642  | 070874  | 071015   |
| <b>PD200<br/>5-1/2" MC</b> | N/A   | N/A   | N/A   | 071039  | 071043   |

**▲ WARNING** - Chuck adapter size is important. A chuck adapter that is too large for the post being driven may cause the post driver to fall from the post, potentially causing serious injury to the operator or bystanders.

Select the proper Chuck I.D. or shape on these pages, then order the part number in the column under your Post Driver's Model Number shown in Chart 1.

**2 to 2.75 lbs / ft Channel posts**  
PD55 - P/N: 070618

Place chuck adapter profile on outline

**1.2 to 1.5 lbs / ft posts**

PD55 - P/N: 070617  
PD110 - P/N: 070628  
PD140 - P/N: 070640

**3 to 4 lbs / ft Channel posts**  
PD110 - P/N: 070630  
PD140 - P/N: 070642

**3 to 4 lbs / ft Channel posts**  
PD55 - P/N: 070619

**2 to 2.75 lbs / ft Channel posts**  
PD110 - P/N: 070629  
PD140 - P/N: 070641

Place chuck adapter profile on outline



**⚠ WARNING - Chuck adapter size is important. A chuck adapter that is too large for the post being driven may cause the post driver to fall from the post, potentially causing serious injury to the operator or bystanders.**

| Chuck & Chuck Adapter<br>Nominal & Actual I.D. / Description | PD-55  | PD-110 | PD-140 |
|--|--------|--------|--------|
| 1" - 0.995 (25.4 mm)   | 070614 | N/A    | N/A    |
| 1-1/2" - 1.495 (38.1 mm)                                     | 070613 | N/A    | N/A    |
| 2" - 1.995 (50.8 mm)   | 070612 | 070625 | N/A    |
| 2-1/2" - 2.495 (63.6 mm)                                     | 070611 | 070624 | 070636 |
| 3" - 2.999 (76.2 mm)   | 070610 | 070623 | 070635 |
| 3-1/2" - 3.495 (88.9 mm)                                     | 070609 | N/A    | N/A    |
| 3-5/8" - 3.620 (92 mm)                                       | N/A    | 070622 | 070634 |
| 3-7/8" - 3.874 (98.4 mm)                                     | MASTER | N/A    | N/A    |
| 4-1/4" - 4.250 (107.9 mm)                                    | N/A    | MASTER | MASTER |
| 1.2 to 1.5 lb Channel Post Adapter                           | 060617 | 070628 | 070640 |
| 2 to 2.75 lb Channel Post Adapter                            | 070618 | 070629 | 070641 |
| 3 to 4 lb Channel Post Adapter                               | 070619 | 070630 | 070642 |
| 4" x 6" (101 mm x 152 mm) H Column for PD140/200             | N/A    | N/A    | 070061 |
| 4" x 6" (101 mm x 152 mm) H Column Driving Cap               | N/A    | N/A    | 070062 |
| 4" x 4" (101 mm x 152 mm) Wood Post for PD140/200            | N/A    | N/A    | 070063 |

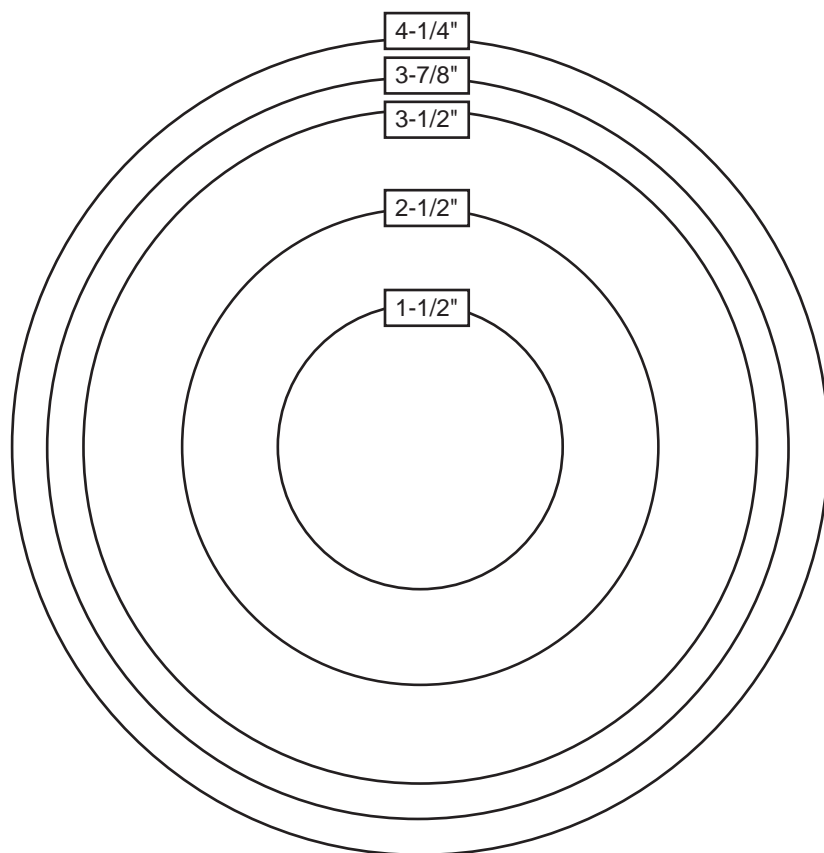

**These diagrams are guidelines, variations due to image reproduction may alter guidelines. For closest accuracy - do not resize images. PD 200 Adapter profiles are not shown.**



*A tradition of quality and service since 1975*

Chuck and Chuck adapter size are important. A chuck that is too large will allow the driver to sit on the post at an angle, diminishing its effectiveness and contributing to conditions that might allow the driver to fall off the post causing injury or death. A post driver should sit as squarely as possible on top of the post. This will result in the impact energy being directed down into the post. Faster more efficient driving is the result.

To choose the proper standard chuck or chuck adapter, use the circles shown on this page, or the shapes on the reverse side which represent the chuck and adapter inside dimensions.

For square, round, H post, T post, rectangular, I, or other symmetrical shaped posts, a round chuck or chuck adapter is best.

Check the circles or shape corresponding to the size of your post and pick the smallest size that has enough clearance, not less than 1/8" (3.1 mm) or more than 5/8" (15.8 mm) larger than the post to be driven. This will allow the post to slide freely. If a round post is to be driven, leave at least 1/8" (3.1 mm) clearance for air exhaust. If the fit is too close, use the next larger chuck.

Channel post, 4" x 4" wood post chuck, and 4" x 6" steel H column drive cap profiles are not shown.

Select the proper Chuck I.D. or shape on these pages, then order the part number in the column under your Post Driver's Model Number shown in Master Chuck and Chuck Adapter Size Chart.

Need a chuck size or shape not shown?  
Ask about ordering a custom chuck.

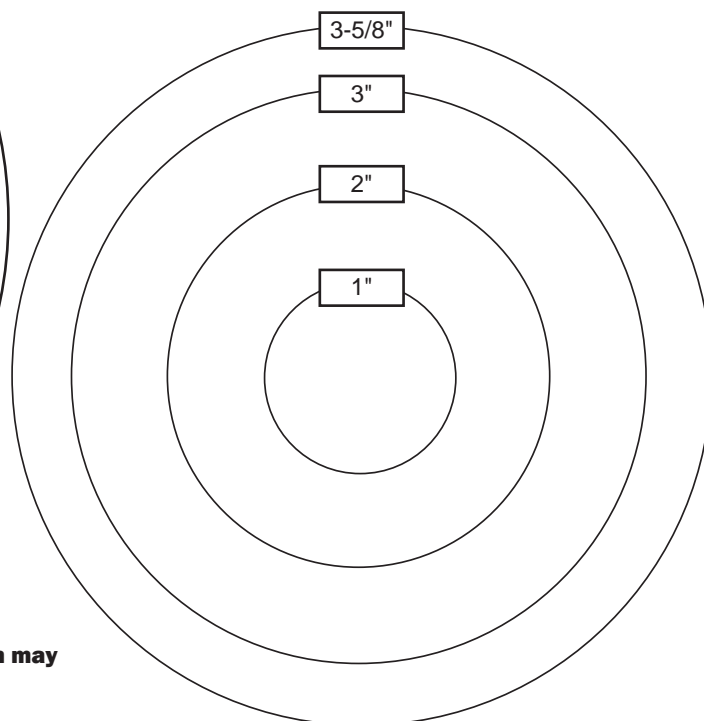

# PL-3

**Hydraulic Post Puller**  
Part No. 071000



**Pneumatic • Hydraulic • Gasoline**  
**Professional Grade Tools**



| Specifications          |  |
|-------------------------|--|
| Model No.               | 071000*                                      |
| Dimension in (mm) HxWxL | 38" x 13-1/4" x 13-1/4"<br>(965 x 337 x 337) |
| Hook Opening in (m)     | 1" (25.4)                                    |
| Cable                   | 3/8" (9.5)                                   |
| Pulling Stroke in (mm)  | 17" (432)                                    |
| Wt. lb (kg)             | 53 (24)                                      |
| Ship Wt. lb (kg)        | 60 (24)                                      |
| Accessories             |  |
| Post Grabber            | 071040                                       |
| Panel Post Grabber      | 071041                                       |
| Tent Stake Grabber      | 071042                                       |

\*The Model PL-3, Part No. 071010, includes pull cable and hook. Post Grabbers shown below are optional accessories



071040 Post Grabber  
Sold Separately



071042 Tent Stake  
Grabber Sold  
Separately



071041 Panel Post  
Grabber Sold  
Separately



*A tradition of quality and service since 1975*

# MP-3

**Manual Post Puller**  
**Part No. 071012**



**Pneumatic • Hydraulic • Gasoline**  
**Professional Grade Tools**



| Specifications                     |                        |
|------------------------------------|------------------------|
| Model No.                          | 071012*                |
| Height Dimension in (m)            | 41 (1.04m)             |
| Base Dimension in (mm)             | 9-1/2 x 12 (241 x 304) |
| Handle Length in (m)               | 60 (1.52)              |
| Wt. lb (kg)                        | 41 (18.7)              |
| Ship Wt. lb (kg)                   | 70 (31.75)             |
| Accessories                        | Pt. No.                |
| Post Grabber                       | 071040                 |
| Chain Assembly                     | 220422                 |
| Panel Post Grabber                 | 071041                 |
| Tent Stake Grabber                 | 071042                 |
| Model MP-3 Manual Post Puller Only | 071013                 |

\*The Model MP-3, Part No. 071012, includes the Chain Assembly, Part No. 220422, and Post Grabber, Part No. 071040



071041 Panel Post  
Grabber Sold  
Separately



071042 Tent Stake  
Grabber Sold  
Separately



071040 Post Grabber



*A tradition of quality and service since 1975*

## QuickSTART

### OPERATING INSTRUCTIONS



Pneumatic • Hydraulic • Gasoline  
Professional Grade Tools

## IMPORTANT SAFETY PRECAUTIONS



**DANGER**

### UNDERGROUND UTILITIES:

Best practices are to contact utility or your municipality office to determine if area is safe to drive post. Driving a post into an underground utility can be **EXTREMELY DANGEROUS**, exposing the operator and those around to potentially life threatening danger. Ensure that a certified locating service has identified all underground utilities prior to beginning your project. (Electric, Gas, Telephone, Water, Sewer, TV Cable, Lawn Sprinklers, etc.)



**DANGER**

### AIR PRESSURE:

The use of the pressure regulator is required for safety. Set the pressure regulator at 90 PSI (6.2 bar). Higher air pressures will not make your driver perform better. Slowly squeeze the air throttle valve lever to start the driver. Opening the throttle valve slowly will prevent a violent start of the driver. Air pressure over 90 PSI (6.2 bar) may result in the driver jumping off the post and causing bodily harm.



**WARNING**

### AIR REQUIREMENTS:

**PD-45:** 30 CFM (0.85m<sup>3</sup>/min.) @ 90 PSI (6.2 bar)

**PD-55:** 42 CFM (1.19 m<sup>3</sup>/min.) @ 90 PSI (6.2 bar)



**WARNING**

### LUBRICATION: YOU MUST OIL YOUR POST DRIVER WHILE IT IS OPERATING:

If using an FRL, set the lubricator on your Filter-Regulator-Lubricator in the air line to the post driver so it will deliver approximately 10 drops of oil per minute. The procedure for lubricating the hose is as follows—Remove the air hose from your post driver and **AFTER SECURING THE AIR LINE SO IT CAN'T WHIP AROUND TO INJURE SOMEONE**, open the lubricator wide open so that a steady stream of oil runs into the air stream after the throttle valve has been activated. Actuate the air throttle valve and run the air through your hose (aimed at a piece of cardboard) until an oil film is seen coming out of the air hose. Periodically check to make sure your driver is receiving oil. Air and oil will be exhausted through the chuck. If in doubt, remove the air line to see if an oil film is being exhausted from the hose end that connects to the driver. If oil is coming out of the hose, reconnect the air hose to the driver.



**WARNING**

### HEARING PROTECTION IS REQUIRED

as the post driver emits noise over 100 dB level.

Operator and bystanders should wear proper PPE (hearing, eye, head and foot protection) during power tool operation. Check surroundings at all times and remove children, animals, and unauthorized persons from the area to prevent possible injury.

*Please refer to the Owner's Manual for this tool or contact a Rhino Service Tech, for additional support, at 866-707-1808.*

## INSPECT

Visually inspect your post driver before use. The interior of the chuck tube should be checked for obstructions or damage to the chuck tube. The outer surfaces of the driver should also be inspected for any defects. Check air-lines for any abnormalities such as bulges, wear spots or tears and replace if necessary.

## CLEAN & LUBRICATE

1. Blow out air lines before coupling them to your post driver. This precaution will help remove any dirt that may have entered an open hose. **DO NOT** turn on pressurized air through an unsecured air line; the air line could whip around causing serious injury.
2. Use SAE 5 wt. Oil in cold weather, SAE 10 wt. Oil for mild weather to 80°C (27°F) and SAE 20 wt. Oil for hot weather.  
We recommend non-detergent oil to prevent degradation of the air hose. Do not use synthetic oil as it impedes atomization of the oil in the air stream.

## START-UP

- Set lubricator to deliver 10 drops of oil per min
- Secure the air line
- Make sure the regulator is set at no more than 90 PSI (6.2 bar)
- Slowly squeeze the air throttle valve lever to start the driver.
- Make sure a steady stream of oil is coming from the lubricator.
- Do not use a chuck or chuck adapter that is too large for the post being driven.
- Place the driver on the post to be driven.
- Properly align the post.

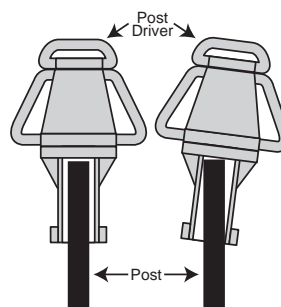

**RIGHT** **WRONG**

Proper alignment of driver and post is important.

*continued..*



## SERVICE INSTRUCTIONS

### EACH USE:

1. Drain the water from the air compressor reservoir.
2. Ensure the air pressure setting on the FRL is correct.

**PD-45:** 30 CFM (0.85m<sup>3</sup>/min.) @ 90 PSI (6.2 bar)

**PD-55:** 42 CFM (1.19 m<sup>3</sup>/min.) @ 90 PSI (6.2 bar)

3. Check the oil level on the FRL and fill when needed.

### ROUTINELY:

1. Drain the filter stage of the FRL regularly, especially in winter. Clean the air filter element as needed.
2. When storing the post driver for prolonged period, add extra oil into the air inlet of the post driver. Slowly roll the driver over to allow the oil to coat all inside surfaces, then stand the driver upright, allow any condensation to drain.

## CONNECTING A PD-55 TO A FILTER-REGULATOR-LUBRICATOR (FRL) AND COMPRESSOR

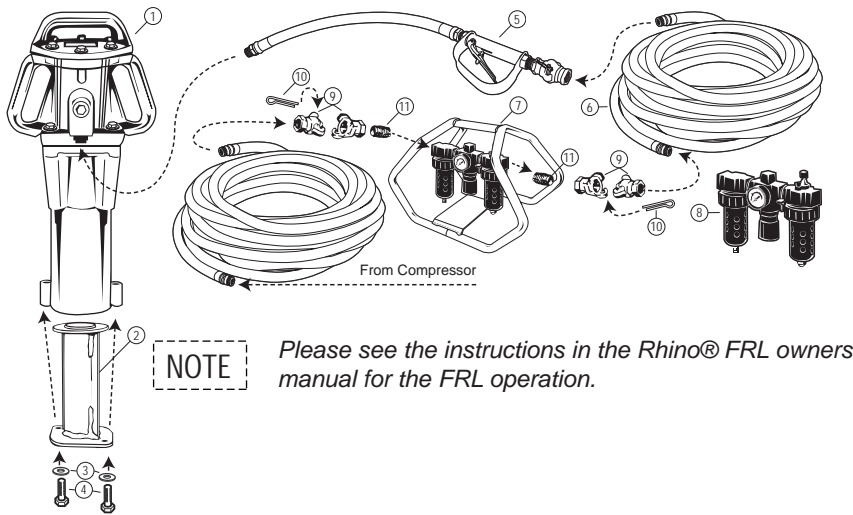

| No. | Part No | DESCRIPTION   |
|-----|---------|---|
| 1   | 070013  | PD-55 Post Driver w/3" (76.2) Chuck                           |
| 2   | 070609  | 3-1/2" (89) Chuck Adapter (See Chart 1 for addtl. options)*** |
| 3   | 517702  | Compression Washers (See Fig. 5)***                           |
| 4   | 500007  | Cap Screws (See Fig. 6)***                                    |
| 5   | 600000  | Throttle Valve Kit  |
| 6   | 607000  | Hose Assembly*  |
| 7   | 225005  | Filter-Regulator-Lubricator (FRL) & Carrier                   |
| 8   | 606000  | Air Line Coupler**  |
| 9   | 606601  | Coupler Safety Clip   |
| 10  | 230041  | Nipple**  |

\* Order to desired length

\*\* Optional on FRL

\*\*\* Optional - includes items 3 and 4

**CHART 1:** Master Chuck and Chuck Adapter sizes and part numbers. Select the proper Chuck I.D. or shape then order the part number under your post driver's model number.

| MASTER CHUCKS          |                   |                 |                 |
|------------------------|-------------------|-----------------|-----------------|
| Chuck Size inches (mm) | Chuck Description | PD-55 Chuck P/N | PD-45 Chuck P/N |
| 3 7/8 (98.4)           | Master Chuck      | 70592           | NA              |
| 3 (76.2)               | Master Chuck      | NA              | 70591           |

| MASTER CHUCK ADAPTERS      |                    |                  |                  |
|----------------------------|--------------------|------------------|------------------|
| Adapter Size inches (mm)   | AdapterDescription | PD-55 AdapterP/N | PD-45 AdapterP/N |
| 3 1/2 (88.9)               | Round Post Adapter | 70609            | NA               |
| 3 (76.2)                   | Round Post Adapter | 70610            | NA               |
| 2-1/2 (63.5)               | Round Post Adapter | 70611            | 70600            |
| 2 (50.8)                   | Round Post Adapter | 70612            | 70601            |
| 1-1/2 (38.1)               | Round Post Adapter | 70613            | 70602            |
| 1 (25.4) Adapter           | Round Post Adapter | 70614            | 70603            |
| 2 (50.8)                   | T-Post             | 70615            | 70871            |
| 1.2 to 1.5 lb Channel Post |                    | 70617            | 70606            |
| 2 to 2.75 lb Channel Post  |                    | 70618            | NA               |
| 3 to 4 lb Channel Post     |                    | 70619            | NA               |

### **WARNING** CHUCK SIZING

A chuck or Chuck Adapter that is too large for the post being driven may contribute to a condition which would allow the post driver to fall or jump from the post causing serious injury or death!

Please note, Chuck and Chuck Adapter sizes shown (Chart 1) are actual inside dimensions of the opening. To select the proper Adapter, measure the longest outside dimension of the post to confirm it will fit inside the opening. In the case of square or rectangular posts measure the longest diagonal from corner to corner.

SCAN QR CODE FOR  
OPERATING MANUAL  
AT RHINOTOOL.COM





# **RHINO TOOL COMPANY, INC.**

## **General Warranty Conditions & Limitations on Liability**

### **Rhino® Limited Warranty Air Operated Post Drivers**

The purchase of a Rhino Tool, as outlined in the warranty terms, automatically serves as the product registration and the start of the customer's One year (12 months) warranty. The Rhino Service Technician will use our number marking on the tool and proof of purchase supplied by the customer, to determine if the tool is still covered by warranty.

**Warranty:** RHINO TOOL COMPANY warrants to the original purchaser for a period of One Year (12 months) from the date of purchase that its Air Operated Post Driver is free from defects in manufacture and materials. In the event of a manufacturing defect during the Warranty period, the Post Driver must be returned freight prepaid to RHINO TOOL COMPANY. If inspection shows a defect in material or workmanship, RHINO will repair or replace without charge.

**Exclusive Remedy:** The sole and exclusive remedy under this Warranty is repair or replacement of the product by RHINO TOOL COMPANY.

**Disclaimer:** In no event shall RHINO TOOL COMPANY be liable for indirect, incidental or consequential damages arising from the sale or use of this product, at any time. RHINO TOOL COMPANY disclaims liability for any implied warranties, including implied warranties of "Merchantability" and "Fitness for a Specific Purpose".

**Limitation:** This Warranty DOES NOT APPLY to the physical appearance of any product or to any product that has been misused, abused, improperly maintained, altered or repaired by unauthorized persons, or to repairs required by normal wear and tear.

**Transferability:** The above Warranty is non-transferable.

### **Important Instructions for obtaining warranty:**

For Warranty Claims contact your dealer or distributor. Proof of purchase date and serial number is required. In the event of a warranty repair, the post driver should be returned to Rhino Tool Company. Rhino's obligation under this Limited Warranty is expressly limited to the repair or replacement, at Rhino's election, of such defective Air Post Driver, which is proved to be defective upon inspection by a Rhino-certified/authorized technician.

This Limited Warranty does not extend to an Air Powered Post Driver which has been subject to misuse, neglect, or accident, nor does it extend to any Air Powered Post Driver which has been repaired, altered, or serviced by unauthorized persons. This Limited Warranty does not cover any damage or adjustments required to any Air Powered Post Driver if such damage or adjustment is caused by the use of supplies, parts, or attachments not sold or approved by Rhino.

EXCEPT AS OTHERWISE PROVIDED HEREIN, RHINO DISCLAIMS ALL OTHER WARRANTIES, EXPRESS OR IMPLIED, INCLUDING, BUT NOT LIMITED TO THE IMPLIED WARRANTIES OF MERCHANTABILITY AND FITNESS FOR A PARTICULAR PURPOSE. UNDER NO CIRCUMSTANCES SHALL RHINO BE LIABLE FOR ANY LOSS OF BUSINESS, REVENUES, OR PROFIT OR OTHER INDIRECT, INCIDENTAL, SPECIAL OR CONSEQUENTIAL DAMAGES OR LOSS ARISING OUT OF ANY DEFECTS IN OR PERFORMANCE OF THE AIR POWERED POST DRIVER, HOWSOEVER CAUSED.

It is recommended that the dealer or customer keep a sales receipt or other record of the purchase date to assist in accurately determining warranty coverage on the tool.

If a repair or replacement is needed within 1 year a Warranty Claim form will need to be completed at that time. Any repair or replacement requires Pre-Approval by a Rhino Authorized Service Technician. Contact [service@rhinotool.com](mailto:service@rhinotool.com) for pre-approval.

**A Tradition of Quality and Service Since 1975**



 [www.rhinotool.com](http://www.rhinotool.com)  
 866-707-1808





**Pneumatic • Hydraulic • Gasoline  
Professional Grade Tools**

**A Tradition of Quality and Service Since 1975**

Rhino Tool Company, Inc.  
1143 W. South St., Kewanee, IL 61443  
Toll-Free: 866-707-1808  
[www.rhinotool.com](http://www.rhinotool.com)

